



Fuji AC Drive Product Comparison

Conversion Information Summary

FRENIC 5000 P11S/G11S vs. MEGA

Dimensional Comparison – FRENIC5000P11S vs. FRENIC-MEGA

FRENIC5000P11S

230VAC, 50/60Hz, 3Ph

HP	Model Number	External Dimensions			Mounting Dimensions	
		W (in)	H (in)	D (in)	W1 (in)	H1 (in)
1/2	-	-	-	-	-	-
1	-	-	-	-	-	-
2	-	-	-	-	-	-
3	-	-	-	-	-	-
5	-	-	-	-	-	-
7.5	FRN007P11S-2UX	8.66	10.24	7.68	7.72	9.37
10	FRN010P11S-2UX	8.66	10.24	7.68	7.72	9.37
15	FRN015P11S-2UX	8.66	10.24	7.68	7.72	9.37
20	FRN020P11S-2UX	9.84	15.75	7.68	8.9	14.88
25	FRN025P11S-2UX	9.84	15.75	7.68	8.9	14.88
30	FRN030P11S-2UX	9.84	15.75	7.68	8.9	14.88
40	FRN040P11S-2UX	13.39	21.65	10.04	9.45	20.87
50	FRN050P11S-2UX	13.39	21.65	10.04	9.45	20.87
60	FRN060P11S-2UX	14.76	24.21	10.63	10.83	23.43
75	FRN070P11S-2UX	14.76	29.13	10.63	10.83	28.35
100	FRN100P11S-2UX	14.76	29.13	10.63	10.83	28.35
125	FRN125P11S-2UX	20.87	29.53	11.22	16.93	28.35
150	FRN150P11S-2UX	26.77	34.65	14.17	22.83	33.46

FRENIC-MEGA (LD)

Model Number	External Dimensions			Mounting Dimensions	
	W (in)	H (in)	D (in)	W1 (in)	H1 (in)
FRNF50G1S-2U	4.33	10.24	5.2	3.78	9.69
FRN001G1S-2U	4.33	10.24	5.71	3.78	9.69
FRN002G1S-2U	5.91	10.24	5.71	5.35	9.69
FRN003G1S-2U	5.91	10.24	5.71	5.35	9.69
FRN005G1S-2U	5.91	10.24	5.71	5.35	9.69
FRN007G1S-2U	8.66	10.24	7.68	7.72	9.37
FRN010G1S-2U	8.66	10.24	7.68	7.72	9.37
FRN015G1S-2U	8.66	10.24	7.68	7.72	9.37
FRN020G1S-2U	8.66	10.24	7.68	7.72	9.37
FRN025G1S-2U	9.84	15.75	7.68	8.90	14.88
FRN030G1S-2U	9.84	15.75	7.68	8.90	14.88
FRN040G1S-2U	9.84	15.75	7.68	8.90	14.88
FRN050G1S-2U	12.6	21.65	10.04	9.45	20.87
FRN060G1S-2U	13.98	24.21	10.63	10.83	23.43
FRN075G1S-2U	13.98	29.13	10.63	10.83	28.35
FRN100G1S-2U	13.98	29.13	10.63	10.83	28.35
FRN125G1S-2U	20.87	29.53	11.22	16.93	28.35
FRN150G1S-2U	24.8	34.65	14.17	22.83	33.46

Dimension Comparison Table

FRENIC 5000 P11S VS MEGA (LD) 230 VAC, 50/60Hz, 3Ph

HP	External Dimensions Comparison			Mounting Dimensions Comparison	
	W (in)	H (in)	D (in)	W1 (in)	H1 (in)
7.5	0 Same	0 Same	0 Same	0 Same	0 Same
10	0 Same	0 Same	0 Same	0 Same	0 Same
15	0 Same	0 Same	0 Same	0 Same	0 Same
20	MEGA 1.18 less	MEGA 5.51 less	0 Same	MEGA 1.18 less	MEGA 5.51 less
25	0 Same	0 Same	0 Same	0 Same	0 Same
30	0 Same	0 Same	0 Same	0 Same	0 Same
40	MEGA 3.55 less	MEGA 5.9 less	MEGA 2.36 less	MEGA 0.55 less	MEGA 5.99 less
50	MEGA 0.79 less	0 Same	0 Same	0 Same	0 Same
60	MEGA 0.78 less	0 Same	0 Same	0 Same	0 Same
75	MEGA 0.78 less	0 Same	0 Same	0 Same	0 Same
100	MEGA 0.78 less	0 Same	0 Same	0 Same	0 Same
125	0 Same	0 Same	0 Same	0 Same	0 Same
150	MEGA 1.97 less	0 Same	0 Same	0 Same	0 Same

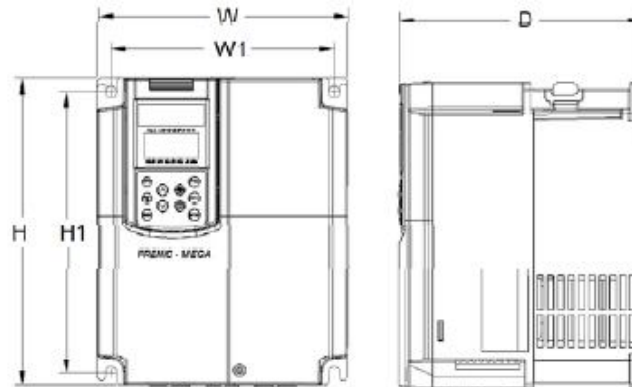

Legend

= Significant Mounting Area Difference

Dimensional Comparison – FRENIC5000P11S vs. FRENIC-MEGA

FRENIC5000P11S

460VAC, 50/60Hz, 3Ph

HP	Model Number	External Dimensions			Mounting Dimensions	
		W (in)	H (in)	D (in)	W1 (in)	H1 (in)
1/2	-	-	-	-	-	-
1	-	-	-	-	-	-
2	-	-	-	-	-	-
3	-	-	-	-	-	-
5	-	-	-	-	-	-
7.5	FRN007P11S-4UX	8.66	10.24	7.68	7.72	9.37
10	FRN010P11S-4UX	8.66	10.24	7.68	7.72	9.37
15	FRN015P11S-4UX	8.66	10.24	7.68	7.72	9.37
20	FRN020P11S-4UX	9.84	15.75	7.68	8.9	14.88
25	FRN025P11S-4UX	9.84	15.75	7.68	8.9	14.88
30	FRN030P11S-4UX	9.84	15.75	7.68	8.9	14.88
40	FRN040P11S-4UX	13.39	21.65	10.04	9.45	20.87
50	FRN050P11S-4UX	13.39	21.65	10.04	9.45	20.87
60	FRN060P11S-4UX	14.76	21.65	10.63	10.83	20.87
75	FRN070P11S-4UX	14.76	26.57	10.63	10.83	25.79
100	FRN100P11S-4UX	14.76	26.57	10.63	10.83	25.79
125	FRN125P11S-4UX	14.76	29.13	10.63	10.83	28.35
150	FRN150P11S-4UX	20.87	29.13	12.4	16.93	27.95
200	FRN200P11S-4UX	20.87	29.13	12.4	16.93	27.95
250	FRN250P11S-4UX	20.87	39.37	14.17	16.93	38.19
300	FRN300P11S-4UX	20.87	39.37	14.17	16.93	38.19
350	FRN350P11S-4UX	26.77	39.37	14.17	22.83	38.19
400	FRN400P11S-4UX	26.77	39.37	14.17	22.83	38.19
450	FRN450P11S-4UX	26.77	39.37	14.17	22.83	38.19
500	FRN500P11S-4UX	26.77	55.12	17.72	22.83	53.94
600	FRN600P11S-4UX	26.77	55.12	17.72	22.83	53.94
700	FRN700P11S-4UX	34.65	55.12	17.72	30.71	53.94
800	FRN800P11S-4UX	34.65	55.12	17.72	30.71	53.94
900	-	-	-	-	-	-
1000	-	-	-	-	-	-

FRENIC-MEGA (LD)

HP	Model Number	External Dimensions			Mounting Dimensions	
		W (in)	H (in)	D (in)	W1 (in)	H1 (in)
1/2	FRNF50G1S-4U	4.33	10.24	5.2	3.78	9.69
1	FRN001G1S-4U	4.33	10.24	5.71	3.78	9.69
2	FRN002G1S-4U	5.91	10.24	5.71	5.35	9.69
3	FRN003G1S-4U	5.91	10.24	5.71	5.35	9.69
5	FRN005G1S-4U	5.91	10.24	5.71	5.35	9.69
7.5	FRN007G1S-4U	8.66	10.24	7.68	7.72	9.37
10	FRN010G1S-4U	8.66	10.24	7.68	7.72	9.37
15	FRN015G1S-4U	8.66	10.24	7.68	7.72	9.37
20	FRN020G1S-4U	8.66	10.24	7.68	7.72	9.37
25	FRN025G1S-4U	9.84	15.75	7.68	8.90	14.88
30	FRN030G1S-4U	9.84	15.75	7.68	8.90	14.88
40	FRN040G1S-4U	9.84	15.75	7.68	8.90	14.88
50	FRN050G1S-4U	12.6	21.65	10.04	9.45	20.87
60	FRN060G1S-4U	12.6	21.65	10.04	9.45	20.87
75	FRN075G1S-4U	13.98	24.21	10.63	10.83	23.43
100	FRN100G1S-4U	13.98	26.57	10.63	10.83	25.79
125	FRN125G1S-4U	13.98	29.13	10.63	10.83	28.35
150	FRN150G1S-4U	20.87	29.13	12.4	16.93	27.95
200	FRN200G1S-4U	20.87	29.13	12.4	16.93	27.95
250	FRN250G1S-4U	20.87	39.37	14.17	16.93	38.19
300	FRN300G1S-4U	20.87	39.37	14.17	16.93	38.19
350	FRN350G1S-4U	26.77	39.37	14.17	22.83	38.19
400	FRN400G1S-4U	26.77	39.37	14.17	22.83	38.19
450	FRN450G1S-4U	26.77	39.37	14.17	22.83	38.19
500	FRN500G1S-4U	26.77	55.12	17.32	22.83	53.94
600	FRN600G1S-4U	26.77	55.12	17.32	22.83	53.94
700	FRN700G1S-4U	34.65	55.12	17.32	30.71	53.94
800	FRN800G1S-4U	34.65	55.12	17.32	30.71	53.94
900	FRN900G1S-4U	39.37	61.02	19.69	35.43	59.84
1000	FRN1000G1S-4U	39.37	61.02	19.69	35.43	59.84

Dimension Comparison Table

FRENIC 5000 P11S VS MEGA (LD) 460 VAC, 50/60Hz, 3Ph

HP	External Dimensions			Mounting Dimensions	
	W (in)	H (in)	D (in)	W1 (in)	H1 (in)
1/2	-	-	-	-	-
1	-	-	-	-	-
2	-	-	-	-	-
3	-	-	-	-	-
5	-	-	-	-	-
7.5	0 Same	0 Same	0 Same	0 Same	0 Same
10	0 Same	0 Same	0 Same	0 Same	0 Same
15	0 Same	0 Same	0 Same	0 Same	0 Same
20	MEGA 1.18 less	MEGA 5.51 less	0 Same	MEGA 1.18 less	MEGA 5.51 less
25	0 Same	0 Same	0 Same	0 Same	0 Same
30	0 Same	0 Same	0 Same	0 Same	0 Same
40	MEGA 3.55 less	MEGA 5.9 less	MEGA 2.36 less	MEGA 0.55 less	MEGA 5.99 less
50	MEGA 0.79 less	0 Same	0 Same	0 Same	0 Same
60	MEGA 2.16 less	0 Same	MEGA 0.59 less	MEGA 1.38 less	0 Same
75	MEGA 0.78 less	MEGA 2.36 less	0 Same	0 Same	MEGA 2.36 less
100	MEGA 0.78 less	0 Same	0 Same	0 Same	0 Same
125	MEGA 0.78 less	0 Same	0 Same	0 Same	0 Same
150	0 Same	0 Same	0 Same	0 Same	0 Same
200	0 Same	0 Same	0 Same	0 Same	0 Same
250	0 Same	0 Same	0 Same	0 Same	0 Same
300	0 Same	0 Same	0 Same	0 Same	0 Same
350	0 Same	0 Same	0 Same	0 Same	0 Same
400	0 Same	0 Same	0 Same	0 Same	0 Same
450	0 Same	0 Same	0 Same	0 Same	0 Same
500	0 Same	0 Same	MEGA 0.40 less	0 Same	0 Same
600	0 Same	0 Same	MEGA 0.40 less	0 Same	0 Same
700	0 Same	0 Same	MEGA 0.40 less	0 Same	0 Same
800	0 Same	0 Same	MEGA 0.40 less	0 Same	0 Same
900	-	-	-	-	-
1000	-	-	-	-	-

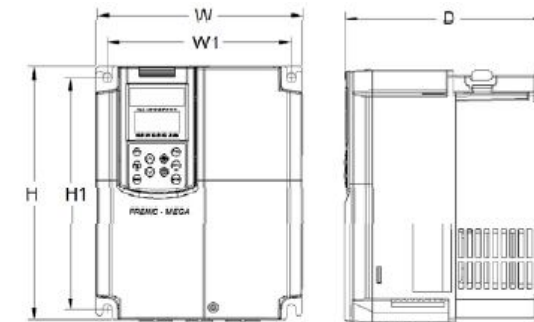

Legend
 = Significant Mounting Area Difference

Dynamic Braking Comparison – FRENIC5000-P11S vs. FRENIC-MEGA
FRENIC5000P11S



230VAC, 50/60Hz, 3Ph

HP	Model Number	Braking Unit Type	Qty	Braking Resistor Type	Qty
1/2	-	-	-	-	-
1	-	-	-	-	-
2	-	-	-	-	-
3	-	-	-	-	-
5	-	-	-	-	-
7.5	FRN007P11S-2UX	Built-In	-	DB3.7-2C	1
10	FRN010P11S-2UX	Built-In	-	DB5.5-2C	1
15	FRN015P11S-2UX	Built-In	-	DB7.5-2C	1
20	FRN020P11S-2UX	BU22-2C	1	DB11-2C	1
25	FRN025P11S-2UX	BU22-2C	1	DB15-2C	1
30	FRN030P11S-2UX	BU22-2C	1	DB22-2C	1
40	FRN040P11S-2UX	BU22-2C	1	DB22-2C	1
50	FRN050P11S-2UX	BU37-2C	1	DB30-2C	1
60	FRN060P11S-2UX	BU37-2C	1	DB37-2C	1
75	FRN075P11S-2UX	BU55-2C	1	DB45-2C	1
100	FRN100P11S-2UX	BU55-2C	1	DB55-2C	1
125	FRN125P11S-2UX	BU90-2C	1	DB75-2C	1
150	FRN150P11S-2UX	BU90-2C	1	DB110-2C	1

FRENIC-MEGA

Model Number	Braking Unit Type	Qty	Braking Resistor Type	Qty
FRNF50G1S-2U	Built-In	-	Built-In	-
FRN001G1S-2U	Built-In	-	Built-In	-
FRN002G1S-2U	Built-In	-	Built-In	-
FRN003G1S-2U	Built-In	-	Built-In	-
FRN005G1S-2U	Built-In	-	Built-In	-
FRN007G1S-2U	Built-In	-	Built-In	-
FRN010G1S-2U	Built-In	-	Built-In	-
FRN015G1S-2U	Built-In	-	Built-In	-
FRN020G1S-2U	Built-In	-	DB11-2C	1
FRN025G1S-2U	Built-In	-	DB15-2C	1
FRN030G1S-2U	Built-In	-	DB22-2C	1
FRN040G1S-2U	Built-In	-	DB22-2C	1
FRN050G1S-2U	BU37-2C	1	DB30-2C	1
FRN060G1S-2U	BU37-2C	1	DB37-2C	1
FRN075G1S-2U	BU55-2C	1	DB45-2C	1
FRN100G1S-2U	BU55-2C	1	DB55-2C	1
FRN125G1S-2U	BU90-2C	1	DB75-2C	1
FRN150G1S-2U	BU90-2C	1	DB110-2C	1

460VAC, 50/60Hz, 3Ph

HP	Model Number	Braking Unit Type	Qty	Braking Resistor Type	Qty
1/2	-	-	-	-	-
1	-	-	-	-	-
2	-	-	-	-	-
3	-	-	-	-	-
5	-	-	-	-	-
7.5	FRN007P11S-4UX	Built-In	-	DB3.7-4C	1
10	FRN010P11S-4UX	Built-In	-	DB5.5-4C	1
15	FRN015P11S-4UX	Built-In	-	DB7.5-4C	1
20	FRN020P11S-4UX	BU22-4C	1	DB11-4C	1
25	FRN025P11S-4UX	BU22-4C	1	DB15-4C	1
30	FRN030P11S-4UX	BU22-4C	1	DB22-4C	1
40	FRN040P11S-4UX	BU22-4C	1	DB22-4C	1
50	FRN050P11S-4UX	BU37-4C	1	DB30-4C	1
60	FRN060P11S-4UX	BU37-4C	1	DB37-4C	1
75	FRN075P11S-4UX	BU55-4C	1	DB45-4C	1
100	FRN100P11S-4UX	BU55-4C	1	DB55-4C	1
125	FRN125P11S-4UX	BU90-4C	1	DB75-4C	1
150	FRN150P11S-4UX	BU90-4C	1	DB110-4C	1
200	FRN200P11S-4UX	BU132-4C	1	DB110-4C	1
250	FRN250P11S-4UX	BU132-4C	1	DB132-4C	1
300	FRN300P11S-4UX	BU220-4C	1	DB160-4C	1
350	FRN350P11S-4UX	BU220-4C	1	DB200-4C	1
400	FRN400P11S-4UX	BU220-4C	1	DB220-4C	1
450	FRN450P11S-4UX	BU220-4C	2	DB160-4C	2
500	FRN500P11S-4UX	BU220-4C	2	DB160-4C	2
600	FRN600P11S-4UX	BU220-4C	2	DB200-4C	2
700	FRN700P11S-4UX	BU220-4C	2	DB200-4C	2
800	FRN800P11S-4UX	BU220-4C	2	DB200-4C	2
900	-	-	-	-	-
1000	-	-	-	-	-

Model Number	Braking Unit Type	Qty	Braking Resistor Type	Qty
FRNF50G1S-4U	Built-In	-	Built-In	-
FRN001G1S-4U	Built-In	-	Built-In	-
FRN002G1S-4U	Built-In	-	Built-In	-
FRN003G1S-4U	Built-In	-	Built-In	-
FRN005G1S-4U	Built-In	-	Built-In	-
FRN007G1S-4U	Built-In	-	Built-In	-
FRN010G1S-4U	Built-In	-	Built-In	-
FRN015G1S-4U	Built-In	-	Built-In	-
FRN020G1S-4U	Built-In	-	DB11.5-4C	1
FRN025G1S-4U	Built-In	-	DB15-4C	1
FRN030G1S-4U	Built-In	-	DB22-4C	1
FRN040G1S-4U	Built-In	-	DB22-4C	1
FRN050G1S-4U	BU37-4C	1	DB30-4C	1
FRN060G1S-4U	BU37-4C	1	DB37-4C	1
FRN075G1S-4U	BU55-4C	1	DB45-4C	1
FRN100G1S-4U	BU55-4C	1	DB55-4C	1
FRN125G1S-4U	BU90-4C	1	DB75-4C	1
FRN150G1S-4U	BU90-4C	1	DB110-4C	1
FRN200G1S-4U	BU132-4C	1	DB110-4C	1
FRN250G1S-4U	BU132-4C	1	DB132-4C	1
FRN300G1S-4U	BU220-4C	1	DB160-4C	1
FRN350G1S-4U	BU220-4C	1	DB132-4C	1
FRN400G1S-4U	BU220-4C	1	DB200-4C	1
FRN450G1S-4U	BU220-4C	1	DB220-4C	1
FRN500G1S-4U	BU220-4C	2	DB220-4C	2
FRN600G1S-4U	BU220-4C	2	DB160-4C	2
FRN700G1S-4U	BU220-4C	2	DB160-4C	2
FRN800G1S-4U	BU220-4C	2	DB200-4C	2
FRN900G1S-4U	BU220-4C	3	DB200-4C	3
FRN1000G1S-4U	BU220-4C	3	DB200-4C	3

DC Reactor – FRENIC 5000 P11S vs. FRENIC-MEGA

External DC Reactors are provided as standard and must be installed for the following ratings:

- P11 units 100HP and above, both 230V and 460V.
- MEGA units 100HP and above, both 230V and 460V.

(P11 vs. MEGA requirements are the same for DC Reactors)

Option Comparison – FRENIC5000P11S vs. FRENIC-MEGA



FRENIC5000P11S

Type	Description	Model Number
I/O	Relay output card	OPC-G11S-RY
	Digital I/O interface card	OPC-G11S-DIO
	Analog I/O interface card	OPC-G11S-AIO
Communication	Modbus RTU	Standard
	-	-
	DeviceNet	OPC-G11S-DEV
	PROFIBUS-DP	OPC-G11S-PDP
	CANopen	OPC-G11S-COP
	Modbus Plus	OPC-G11S-MBP
	Interbus-S	OPC-G11S-IBS
	T-link interface card	OPC-G11S-TL
Feedback		
Drive Software	Interface Software	Drive Configuration Software 1.0
Enclosure	NEMA 1 Cover Kit	30HP and below are NEMA 1 as standard. NEMA 1 kits are optional for 40HP and above.

FRENIC-MEGA

Type	Description	Model Number
I/O	Relay output card	OPC-G1-RY
	Digital input interface card	OPC-G1-DI
	Digital output interface card	OPC-G1-DO
	Analog I/O interface card	OPC-G1-AIO
	115V I/O Card	OPC-ALL-115V
Communication	Modbus RTU	Standard
	Ethernet card	OPC-G1-ETH
	DeviceNet	OPC-G1-DEV
	PROFIBUS-DP	OPC-G1-PDP
	CANopen	OPC-G1-COP
	-	-
	-	-
	T-link interface card	OPC-G1-TL
Feedback	CC-link card	OPC-G1-CCL
	PG interface card (supporting 12V)	OPC-G1-PG
	PG interface card (supporting 5V)	OPC-G1-PG2
Drive Software	PG synchronization card	OPC-G1-PG22
	Interface Software	FRENIC Loader 3.2EN Software
Enclosure	NEMA 1 Cover Kit	Available as option for all HP ratings

New feature highlights for MEGA:

- Safety Input that is compliant with EN954-1, Category 3.
- Improved corrosion resistance via Nickel and Tin plating of the copper bus bars.
- Cooling fan connections are further protected with additional coatings and full connector sealing.
- 3 internal option points vs. 2 for P11S/G11S are available which allow for multiple combinations of option cards to be used simultaneously.
- Expanded HP range which is now up to 1000HP (LD) vs. 800 HP P11.
- A customizable logic area has been added to allow the user to perform simple logic inside the inverter without having to use external relays and timers.

*P11S/G11S available in NEMA 1 and 4, MEGA NEMA 1 only

Note: When replacing P11S/G11S with MEGA that NEMA 1 cover is standard on P11S/G11S up to 30 HP. NEMA 1 cover is optional for all MEGA sizes.

Dimensional Comparison – FRENIC5000G11S vs. FRENIC-MEGA



FRENIC5000G11S

230VAC, 50/60Hz, 3Ph

HP	Model Number	External Dimensions			Mounting Dimensions	
		W (in)	H (in)	D (in)	W1 (in)	H1 (in)
1/4	FRNF25G11S-2UX	4.33	10.24	5.12	3.78	9.69
1/2	FRNF50G11S-2UX	4.33	10.24	5.12	3.78	9.69
1	FRN001G11S-2UX	4.33	10.24	5.71	3.78	9.69
2	FRN002G11S-2UX	5.91	10.24	5.71	5.35	9.69
3	FRN003G11S-2UX	5.91	10.24	5.71	5.35	9.69
5	FRN005G11S-2UX	5.91	10.24	5.71	5.35	9.69
7.5	FRN007G11S-2UX	8.66	10.24	7.68	7.72	9.37
7.5	FRN007G11S-2UX	8.66	10.24	7.68	7.72	9.37
10	FRN010G11S-2UX	8.66	10.24	7.68	7.72	9.37
15	FRN015G11S-2UX	9.84	15.75	7.68	8.9	14.88
20	FRN020G11S-2UX	9.84	15.75	7.68	8.9	14.88
25	FRN025G11S-2UX	9.84	15.75	7.68	8.9	14.88
30	FRN030G11S-2UX	9.84	15.75	7.68	8.9	14.88
40	FRN040G11S-2UX	13.39	21.65	10.04	9.45	20.87
50	FRN050G11S-2UX	14.76	24.21	10.63	10.83	23.43
60	FRN060G11S-2UX	14.76	29.13	10.63	10.83	28.35
75	FRN075G11S-2UX	14.76	29.13	10.63	10.83	28.35
100	FRN100G11S-2UX	20.87	29.53	11.22	16.93	28.35
125	FRN125G11S-2UX	26.77	34.65	14.17	22.83	33.46

FRENIC-MEGA (HD)

Model Number	External Dimensions			Mounting Dimensions	
	W (in)	H (in)	D (in)	W1 (in)	H1 (in)
-	-	-	-	-	-
FRNF50G1S-2U	4.33	10.24	5.2	3.78	9.69
FRN001G1S-2U	4.33	10.24	5.71	3.78	9.69
FRN002G1S-2U	5.91	10.24	5.71	5.35	9.69
FRN003G1S-2U	5.91	10.24	5.71	5.35	9.69
FRN005G1S-2U	5.91	10.24	5.71	5.35	9.69
FRN007G1S-2U	8.66	10.24	7.68	7.72	9.37
FRN010G1S-2U	8.66	10.24	7.68	7.72	9.37
FRN015G1S-2U	8.66	10.24	7.68	7.72	9.37
FRN020G1S-2U	8.66	10.24	7.68	7.72	9.37
FRN025G1S-2U	9.84	15.75	7.68	8.90	14.88
FRN030G1S-2U	9.84	15.75	7.68	8.90	14.88
FRN040G1S-2U	9.84	15.75	7.68	8.90	14.88
FRN050G1S-2U	12.6	21.65	10.04	9.45	20.87
FRN060G1S-2U	13.98	24.21	10.63	10.83	23.43
FRN075G1S-2U	13.98	29.13	10.63	10.83	28.35
FRN100G1S-2U	13.98	29.13	10.63	10.83	28.35
FRN125G1S-2U	20.87	29.53	11.22	16.93	28.35
FRN150G1S-2U	24.8	34.65	14.17	22.83	33.46

Dimension Comparison Table

FRENIC 5000 G11S VS MEGA (HD) 230 VAC, 50/60Hz, 3Ph

HP	External Dimensions			Mounting Dimensions	
	W (in)	H (in)	D (in)	W1 (in)	H1 (in)
1/4	-	-	-	-	-
1/2	0 Same	0 Same	MEGA 0.08 more	0 Same	0 Same
1	0 Same	0 Same	0 Same	0 Same	0 Same
2	0 Same	0 Same	0 Same	0 Same	0 Same
3	0 Same	0 Same	0 Same	0 Same	0 Same
5	0 Same	0 Same	0 Same	0 Same	0 Same
7.5	0 Same	0 Same	0 Same	0 Same	0 Same
7.5	0 Same	0 Same	0 Same	0 Same	0 Same
10	0 Same	0 Same	0 Same	0 Same	0 Same
15	MEGA 1.18 less	MEGA 5.51 less	0 Same	MEGA 1.18 less	MEGA 5.51 less
20	0 Same	0 Same	0 Same	0 Same	0 Same
25	0 Same	0 Same	0 Same	0 Same	0 Same
30	0 Same	0 Same	0 Same	0 Same	0 Same
40	MEGA 0.79 less	0 Same	0 Same	0 Same	0 Same
50	MEGA 0.78 less	0 Same	0 Same	0 Same	0 Same
60	MEGA 0.78 less	0 Same	0 Same	0 Same	0 Same
75	MEGA 0.78 less	0 Same	0 Same	0 Same	0 Same
100	0 Same	0 Same	0 Same	0 Same	0 Same
125	MEGA 1.97 less	0 Same	0 Same	0 Same	0 Same

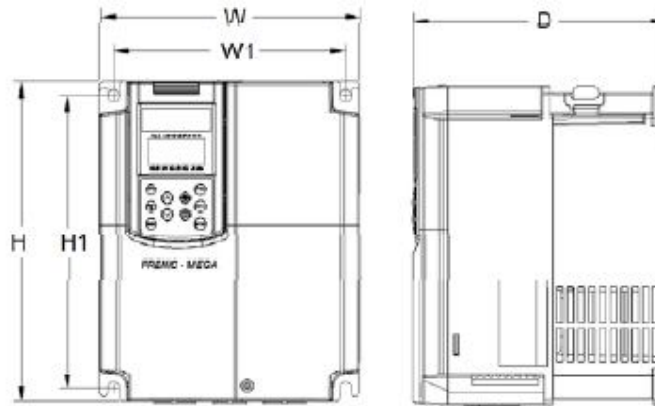

Legend
 = Significant Mounting Area Difference

Dimensional Comparison – FRENIC5000G11S vs. FRENIC-MEGA

FRENIC5000G11S

460VAC, 50/60Hz, 3Ph

HP	Model Number	External Dimensions			Mounting Dimensions	
		W (in)	H (in)	D (in)	W1 (in)	H1 (in)
1/4	FRNF25G11S-4UX	4.33	10.24	5.12	3.78	9.69
1/2	FRNF50G11S-4UX	4.33	10.24	5.12	3.78	9.69
1	FRN001G11S-4UX	4.33	10.24	5.71	3.78	9.69
2	FRN002G11S-4UX	5.91	10.24	5.71	5.35	9.69
3	FRN003G11S-4UX	5.91	10.24	5.71	5.35	9.69
5	FRN005G11S-4UX	5.91	10.24	5.71	5.35	9.69
7.5	FRN007G11S-4UX	8.66	10.24	7.68	7.72	9.37
7.5	FRN007G11S-4UX	8.66	10.24	7.68	7.72	9.37
10	FRN010G11S-4UX	8.66	10.24	7.68	7.72	9.37
15	FRN015G11S-4UX	9.84	15.75	7.68	8.9	14.88
20	FRN020G11S-4UX	9.84	15.75	7.68	8.9	14.88
25	FRN025G11S-4UX	9.84	15.75	7.68	8.9	14.88
30	FRN030G11S-4UX	9.84	15.75	7.68	8.9	14.88
40	FRN040G11S-4UX	13.39	21.65	10.04	9.45	20.87
50	FRN050G11S-4UX	14.76	21.65	10.63	10.83	20.87
60	FRN060G11S-4UX	14.76	26.57	10.63	10.83	25.79
75	FRN075G11S-4UX	14.76	26.57	10.63	10.83	25.79
100	FRN100G11S-4UX	14.76	29.13	10.63	10.83	28.35
125	FRN125G11S-4UX	20.87	29.13	12.4	16.93	27.95
150	FRN150G11S-4UX	20.87	29.13	12.4	16.93	27.95
200	FRN200G11S-4UX	20.87	39.37	14.17	16.93	38.19
250	FRN250G11S-4UX	20.87	39.37	14.17	16.93	38.19
300	FRN300G11S-4UX	26.77	39.37	14.17	22.83	38.19
350	FRN350G11S-4UX	26.77	39.37	14.17	22.83	38.19
400	FRN400G11S-4UX	26.77	55.12	17.72	22.83	53.94
450	FRN450G11S-4UX	26.77	55.12	17.72	22.83	53.94
500	FRN500G11S-4UX	34.65	55.12	17.72	30.71	53.94
600	FRN600G11S-4UX	34.65	55.12	17.72	30.71	53.94
800	-	-	-	-	-	-
900	-	-	-	-	-	-

FRENIC-MEGA (HD)

HP	Model Number	External Dimensions			Mounting Dimensions	
		W (in)	H (in)	D (in)	W1 (in)	H1 (in)
1/4	-	-	-	-	-	-
1/2	FRNF50G1S-4U	4.33	10.24	5.2	3.78	9.69
1	FRN001G1S-4U	4.33	10.24	5.71	3.78	9.69
2	FRN002G1S-4U	5.91	10.24	5.71	5.35	9.69
3	FRN003G1S-4U	5.91	10.24	5.71	5.35	9.69
5	FRN005G1S-4U	5.91	10.24	5.71	5.35	9.69
7.5	FRN007G1S-4U	8.66	10.24	7.68	7.72	9.37
7.5	FRN010G1S-4U	8.66	10.24	7.68	7.72	9.37
10	FRN015G1S-4U	8.66	10.24	7.68	7.72	9.37
15	FRN020G1S-4U	8.66	10.24	7.68	7.72	9.37
20	FRN025G1S-4U	9.84	15.75	7.68	8.90	14.88
25	FRN030G1S-4U	9.84	15.75	7.68	8.90	14.88
30	FRN040G1S-4U	9.84	15.75	7.68	8.90	14.88
40	FRN050G1S-4U	12.6	21.65	10.04	9.45	20.87
50	FRN060G1S-4U	12.6	21.65	10.04	9.45	20.87
60	FRN075G1S-4U	13.98	24.21	10.63	10.83	23.43
75	FRN100G1S-4U	13.98	26.57	10.63	10.83	25.79
100	FRN125G1S-4U	13.98	29.13	10.63	10.83	28.35
125	FRN150G1S-4U	20.87	29.13	12.4	16.93	27.95
150	FRN200G1S-4U	20.87	29.13	12.4	16.93	27.95
200	FRN250G1S-4U	20.87	39.37	14.17	16.93	38.19
250	FRN300G1S-4U	20.87	39.37	14.17	16.93	38.19
300	FRN350G1S-4U	26.77	39.37	14.17	22.83	38.19
350	FRN450G1S-4U	26.77	39.37	14.17	22.83	38.19
400	FRN500G1S-4U	26.77	55.12	17.32	22.83	53.94
450	FRN600G1S-4U	26.77	55.12	17.32	22.83	53.94
500	FRN700G1S-4U	34.65	55.12	17.32	30.71	53.94
600	FRN800G1S-4U	34.65	55.12	17.32	30.71	53.94
800	FRN900G1S-4U	39.37	61.02	19.69	35.43	59.84
900	FRN1000G1S-4U	39.37	61.02	19.69	35.43	59.84

Dimension Comparison Table

FRENIC 5000 G11S VS MEGA (HD) 460 VAC, 50/60Hz, 3Ph

HP	External Dimensions			Mounting Dimensions	
	W (in)	H (in)	D (in)	W1 (in)	H1 (in)
0.25	-	-	-	-	-
0.5	0 Same	0 Same	MEGA 0.08 more	0 Same	0 Same
1	0 Same	0 Same	0 Same	0 Same	0 Same
2	0 Same	0 Same	0 Same	0 Same	0 Same
3	0 Same	0 Same	0 Same	0 Same	0 Same
5	0 Same	0 Same	0 Same	0 Same	0 Same
7.5	0 Same	0 Same	0 Same	0 Same	0 Same
7.5	0 Same	0 Same	0 Same	0 Same	0 Same
10	0 Same	0 Same	0 Same	0 Same	0 Same
15	MEGA 1.18 less	MEGA 5.51 less	0 Same	MEGA 1.18 less	MEGA 5.51 less
20	0 Same	0 Same	0 Same	0 Same	0 Same
25	0 Same	0 Same	0 Same	0 Same	0 Same
30	0 Same	0 Same	0 Same	0 Same	0 Same
40	MEGA 0.79 less	0 Same	0 Same	0 Same	0 Same
50	MEGA 2.16 less	0 Same	MEGA 0.59 less	MEGA 1.38 less	0 Same
60	MEGA 0.78 less	MEGA 2.36 less	0 Same	0 Same	MEGA 2.36 less
75	MEGA 0.78 less	0 Same	0 Same	0 Same	0 Same
100	MEGA 0.78 less	0 Same	0 Same	0 Same	0 Same
125	0 Same	0 Same	0 Same	0 Same	0 Same
150	0 Same	0 Same	0 Same	0 Same	0 Same
200	0 Same	0 Same	0 Same	0 Same	0 Same
250	0 Same	0 Same	0 Same	0 Same	0 Same
300	0 Same	0 Same	0 Same	0 Same	0 Same
350	0 Same	0 Same	0 Same	0 Same	0 Same
400	0 Same	0 Same	MEGA 0.4 less	0 Same	0 Same
450	0 Same	0 Same	MEGA 0.4 less	0 Same	0 Same
500	0 Same	0 Same	MEGA 0.4 less	0 Same	0 Same
600	0 Same	0 Same	MEGA 0.4 less	0 Same	0 Same
800	-	-	-	-	-
900	-	-	-	-	-

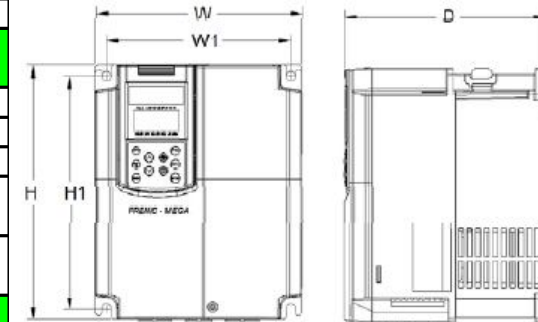

Legend
 = Significant Mounting Area Difference

Dynamic Braking Comparison – FRENIC5000G11S vs. FRENIC-MEGA
FRENIC5000G11S

230VAC, 50/60Hz, 3Ph

HP	Model Number	Braking Unit Type	Qty	Braking Resistor Type	Qty
1/4	FRNF25G11S-2UX	Built-In	-	DB0.75-2C	1
0.5	FRNF50G11S-2UX	Built-In	-	DB0.75-2C	1
1	FRN001G11S-2UX	Built-In	-	DB0.75-2C	1
2	FRN002G11S-2UX	Built-In	-	DB2.2-2C	1
3	FRN003G11S-2UX	Built-In	-	DB2.2-2C	1
5	FRN005G11S-2UX	Built-In	-	DB3.7-2C	1
7.5	FRN007G11S-2UX	Built-In	-	DB5.5-2C	1
7.5	FRN007G11S-2UX	Built-In	-	DB5.5-2C	1
10	FRN010G11S-2UX	Built-In	-	DB7.5-2C	1
15	FRN015G11S-2UX	BU22-2C	1	DB11-2C	1
20	FRN020G11S-2UX	BU22-2C	1	DB15-2C	1
25	FRN025G11S-2UX	BU22-2C	1	DB22-2C	1
30	FRN030G11S-2UX	BU22-2C	1	DB22-2C	1
40	FRN040G11S-2UX	BU37-2C	1	DB30-2C	1
50	FRN050G11S-2UX	BU37-2C	1	DB37-2C	1
60	FRN060G11S-2UX	BU55-2C	1	DB45-2C	1
75	FRN075G11S-2UX	BU55-2C	1	DB55-2C	1
100	FRN100G11S-2UX	BU90-2C	1	DB75-2C	1
125	FRN125G11S-2UX	BU90-2C	1	DB110-2C	1

460VAC, 50/60Hz, 3Ph

HP	Model Number	Braking Unit Type	Qty	Braking Resistor Type	Qty
1/2	FRNF50G11S-4UX	Built-In	-	DB0.75-4C	1
1	FRN001G11S-4UX	Built-In	-	DB0.75-4C	1
2	FRN002G11S-4UX	Built-In	-	DB2.2-4C	1
3	FRN003G11S-4UX	Built-In	-	DB2.2-4C	1
5	FRN005G11S-4UX	Built-In	-	DB3.7-4C	1
7.5	FRN007G11S-4UX	Built-In	-	DB5.5-4C	1
7.5	FRN007G11S-4UX	Built-In	-	DB5.5-4C	1
10	FRN010G11S-4UX	Built-In	-	DB7.5-4C	1
15	FRN015G11S-4UX	BU22-4C	-	DB11-4C	1
20	FRN020G11S-4UX	BU22-4C	1	DB15-4C	1
25	FRN025G11S-4UX	BU22-4C	1	DB22-4C	1
30	FRN030G11S-4UX	BU22-4C	1	DB22-4C	1
40	FRN040G11S-4UX	BU37-4C	1	DB30-4C	1
50	FRN050G11S-4UX	BU37-4C	1	DB37-4C	1
60	FRN060G11S-4UX	BU55-4C	1	DB45-4C	1
75	FRN075G11S-4UX	BU55-4C	1	DB55-4C	1
100	FRN100G11S-4UX	BU90-4C	1	DB75-4C	1
125	FRN125G11S-4UX	BU90-4C	1	DB110-4C	1
150	FRN150G11S-4UX	BU132-4C	1	DB110-4C	1
200	FRN200G11S-4UX	BU132-4C	1	DB132-4C	1
250	FRN250G11S-4UX	BU220-4C	1	DB160-4C	1
300	FRN300G11S-4UX	BU220-4C	1	DB200-4C	1
350	FRN350G11S-4UX	BU220-4C	1	DB220-4C	1
400	FRN400G11S-4UX	BU220-4C	2	DB160-4C	2
450	FRN450G11S-4UX	BU220-4C	2	DB160-4C	2
500	FRN500G11S-4UX	BU220-4C	2	DB200-4C	2
600	FRN600G11S-4UX	BU220-4C	2	DB200-4C	2
800	-	-	-	-	-
900	-	-	-	-	-
1000	-	-	-	-	-

FRENIC-MEGA

Model Number	Braking Unit Type	Qty	Braking Resistor Type	Qty
-	-	-	-	-
FRNF50G1S-2U	Built-In	-	Built-In	-
FRN001G1S-2U	Built-In	-	Built-In	-
FRN002G1S-2U	Built-In	-	Built-In	-
FRN003G1S-2U	Built-In	-	Built-In	-
FRN005G1S-2U	Built-In	-	Built-In	-
FRN007G1S-2U	Built-In	-	Built-In	-
FRN010G1S-2U	Built-In	-	Built-In	-
FRN015G1S-2U	Built-In	-	Built-In	-
FRN020G1S-2U	Built-In	-	DB11-2C	1
FRN025G1S-2U	Built-In	-	DB15-2C	1
FRN030G1S-2U	Built-In	-	DB22-2C	1
FRN040G1S-2U	Built-In	-	DB22-2C	1
FRN050G1S-2U	BU37-2C	1	DB30-2C	1
FRN060G1S-2U	BU37-2C	1	DB37-2C	1
FRN075G1S-2U	BU55-2C	1	DB45-2C	1
FRN100G1S-2U	BU55-2C	1	DB55-2C	1
FRN125G1S-2U	BU90-2C	1	DB75-2C	1
FRN150G1S-2U	BU90-2C	1	DB110-2C	1

Model Number	Braking Unit Type	Qty	Braking Resistor Type	Qty
FRNF50G1S-4U	Built-In	-	Built-In	-
FRN001G1S-4U	Built-In	-	Built-In	-
FRN002G1S-4U	Built-In	-	Built-In	-
FRN003G1S-4U	Built-In	-	Built-In	-
FRN005G1S-4U	Built-In	-	Built-In	-
FRN007G1S-4U	Built-In	-	Built-In	-
FRN010G1S-4U	Built-In	-	Built-In	-
FRN015G1S-4U	Built-In	-	Built-In	-
FRN020G1S-4U	Built-In	-	DB11-4C	1
FRN025G1S-4U	Built-In	-	DB15-4C	1
FRN030G1S-4U	Built-In	-	DB22-4C	1
FRN040G1S-4U	Built-In	-	DB22-4C	1
FRN050G1S-4U	BU37-4C	1	DB30-4C	1
FRN060G1S-4U	BU37-4C	1	DB37-4C	1
FRN075G1S-4U	BU55-4C	1	DB45-4C	1
FRN100G1S-4U	BU55-4C	1	DB55-4C	1
FRN125G1S-4U	BU90-4C	1	DB75-4C	1
FRN150G1S-4U	BU90-4C	1	DB110-4C	1
FRN200G1S-4U	BU132-4C	1	DB110-4C	1
FRN250G1S-4U	BU132-4C	1	DB132-4C	1
FRN300G1S-4U	BU220-4C	1	DB160-4C	1
FRN350G1S-4U	BU220-4C	1	DB200-4C	1
FRN450G1S-4U	BU220-4C	1	DB220-4C	1
FRN500G1S-4U	BU220-4C	2	DB160-4C	2
FRN600G1S-4U	BU220-4C	2	DB160-4C	2
FRN700G1S-4U	BU220-4C	2	DB200-4C	2
FRN800G1S-4U	BU220-4C	2	DB200-4C	2
FRN900G1S-4U	BU220-4C	3	DB200-4C	3
FRN1000G1S-4U	BU220-4C	3	DB220-4C	3
FRN1000G1S-4U	BU220-4C	3	DB200-4C	3

DC Reactor – FRENIC 5000 G11s vs. FRENIC-MEGA

External DC Reactors are provided as standard and must be installed for the following ratings:

- P11 units 100HP and above, both 230V and 460V.
- MEGA units 100HP and above, both 230V and 460V.

(P11 vs. MEGA requirements are the same for DC Reactors)

Option Comparison – FRENIC5000G11S vs. FRENIC-MEGA

FRENIC5000G11S

Type	Description	Model Number
I/O	Relay output card	OPC-G11S-RY
	Digital I/O interface card	OPC-G11S-DIO
	Analog I/O interface card	OPC-G11S-AIO
	115V I/O Card	OPC-ALL-115V
Communication	Modbus RTU	Standard
	-	-
	DeviceNet	OPC-G11S-DEV
	PROFIBUS-DP	OPC-G11S-PDP
	CANopen	OPC-G11S-COP
	Modbus Plus	OPC-G11S-MBP
	Interbus-S	OPC-G11S-IBS
	T-link interface card	OPC-G11S-TL
Feedback	PG interface card (supporting 12V)	OPC-G11S-PG
	PG interface card (supporting 5V)	OPC-G11S-PG2
	PG synchronization card	OPC-G11S-SY
Drive Software	Interface Software	Drive Configuration Software 1.0
Enclosure	NEMA 1 Cover Kit	30HP and below are NEMA 1 as standard. NEMA 1 kits are optional for 40HP and above.

FRENIC-MEGA

Type	Description	Model Number
I/O	Relay output card	OPC-G1-RY
	Digital input interface card	OPC-G1-DI
	Digital output interface card	OPC-G1-DO
	Analog I/O interface card	OPC-G1-AIO
	115V I/O Card	OPC-ALL-115V
Communication	Modbus RTU	Standard
	Ethernet card	OPC-G1-ETH
	DeviceNet	OPC-G1-DEV
	PROFIBUS-DP	OPC-G1-PDP
	CANopen	OPC-G1-COP
	-	-
	-	-
	T-link interface card	OPC-G1-TL
	CC-link card	OPC-G1-CCL
Feedback	PG interface card (supporting 12V)	OPC-G1-PG
	PG interface card (supporting 5V)	OPC-G1-PG2
	PG synchronization card	OPC-G1-PG22
Drive Software	Interface Software	FRENIC Loader 3.2EN Software
Enclosure	NEMA 1 Cover Kit	Available as option for all HP ratings

New feature highlights for MEGA:

- Safety Input that is compliant with EN954-1, Category 3.
- Improved corrosion resistance via Nickel and Tin plating of the copper bus bars.
- Cooling fan connections are further protected with additional coatings and full connector sealing.
- 3 internal option points vs. 2 for P11S/G11S are available which allow for multiple combinations of option cards to be used simultaneously.
- Expanded HP range which is now up to 1000HP (LD) vs. 800 HP P11.
- A customizable logic area has been added to allow the user to perform simple logic inside the inverter without having to use external relays and timers.

*P11S/G11S available in NEMA 1 and 4, MEGA NEMA 1 only

Note: When replacing P11/G11 with MEGA that NEMA 1 cover is standard on P11S/G11S up to 30 HP. NEMA 1 cover is optional for all MEGA sizes.



Keypad Comparison – FRENIC5000P11S/G11S
vs.
FRENIC-MEGA



FRENIC5000P11S

Menu No.	Menu Name
-	-
1	Data Setting
2	Data Checking
3	Operation Monitoring
4	I/O Check
5	Maintenance Information
6	Load Factor Measurement
7	Alarm Information
8	Alarm Cause
9	Data Copy
-	-
-	-

FRENIC-MEGA

Menu No.	Menu Name
0	Quick Setup
1	Data Setting
2	Data Checking
3	Operation Monitoring
4	I/O Check
5	Maintenance Information
6	Alarm Information
7	Alarm Cause
8	Data Copy
9	Load Factor Measurement
10	User Setting
11	Communication Debugging

LEGEND
= Different Menu Number
 = New Feature
 = N/A

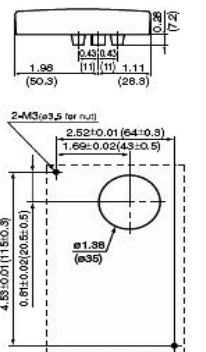
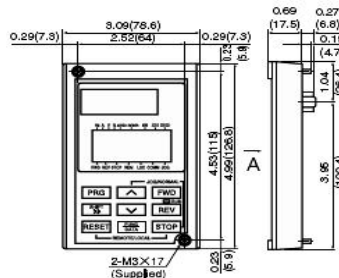

Dimensions of panel cutting (viewed from 'A')

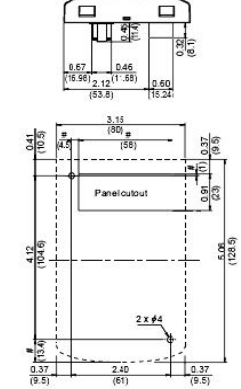
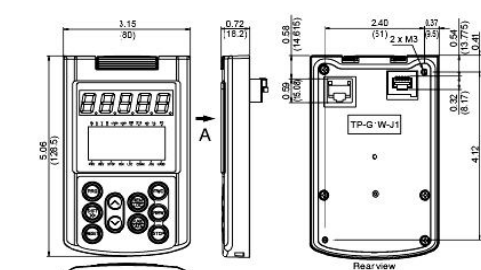

Dimensions of panel cutting (viewed from 'A')

Standard Keypad
Hardware Differences:

-P11S/G11S - Standard NEMA 1. Optional keypad for NEMA 4/12 Indoor Use. Requires special extension cable for remote mounting.

-MEGA – Standard NEMA 4/12 Indoor Use Uses standard Cat 5 cable for remote mounting.

Key Initial Setup Parameters – FRENIC5000P11S/G11S vs. FRENIC-MEGA



FRENIC5000P11S/G11S



FRENIC-MEGA

Func. No.	Parameter Name
F01	Operation Method
F02	Operation method
F03	Maximum frequency 1
F04	Base frequency 1
F05	Rated voltage 1 (at Base frequency 1)
F07	Acceleration time 1
F08	Deceleration time 1
F09	Torque boost 1
F10	Electronic thermal overload relay for motor 1 (Select)
F11	Electronic thermal overload relay for motor 1 (Level)
F14	Restart mode after momentary power failure
F16	Frequency limiter (Low)
F26	Motor sound (Carrier freq.)
-	-
P02	Motor 1 (Capacity)
P03	Motor 1 (Rated Current)
P04	Motor 1 (Tuning)
-	-

Func. No.	Parameter Name
F01	Operation Method
F02	Operation method
F03	Maximum frequency 1
F04	Base frequency 1
F05	Rated voltage 1 (at Base frequency 1)
F07	Acceleration time 1
F08	Deceleration time 1
F09	Torque boost 1
F10	Electronic thermal overload relay for motor 1 (Select)
F11	Electronic thermal overload relay for motor 1 (Level)
F14	Restart mode after momentary power failure
F16	Frequency limiter (Low)
F26	Motor sound (Carrier freq.)
-	-
E52	Keypad (Menu display mode)
P02	Motor 1 (Capacity)
P03	Motor 1 (Rated Current)
P04	Motor 1 (Tuning)
-	-
P99	Motor Selection [Hp vs. kW]

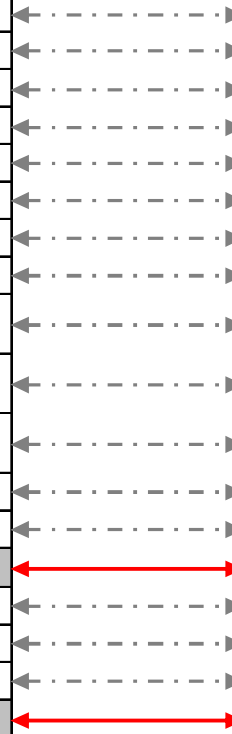

Fuji Electric: The Solution for Your Application

Thank You

1-888-900-FUJI (3854)

www.americas.fujielectric.com

