

## Panel-mount Adapter "MA-E1"

Thank you for purchasing this panel-mount adapter "MA-E1." This adapter allows you to install your FRENIC-Multi to the panel of your system by making use of the mounting holes used for your conventional inverter (FVR-E11S-2, 0.75 kW or below or 3.7 kW; FVR-E11S-4, 3.7 kW; and FVR-E11S-7, 0.4 kW or below or 2.2 kW).

(The FVR-E11S-2, 1.5/2.2 kW and FVR-E11S-4, 0.4 to 2.2 kW can be replaced with the FRENIC-Multi series without this adapter.)

### 1. Check that:

- (1) A panel-mount adapter is contained in the package.
- (2) The panel-mount adapter is not damaged or dented during transportation.
- (3) The panel-mount adapter is the model you ordered. You may check the model name (see the table below) printed on the nameplate (shown at the right).
- (4) For the model MA-E1-3.7, four screws (M4x12) are also contained in the package.

If you suspect the product is not working properly or if you have any questions about the product, contact your Fuji Electric representative.

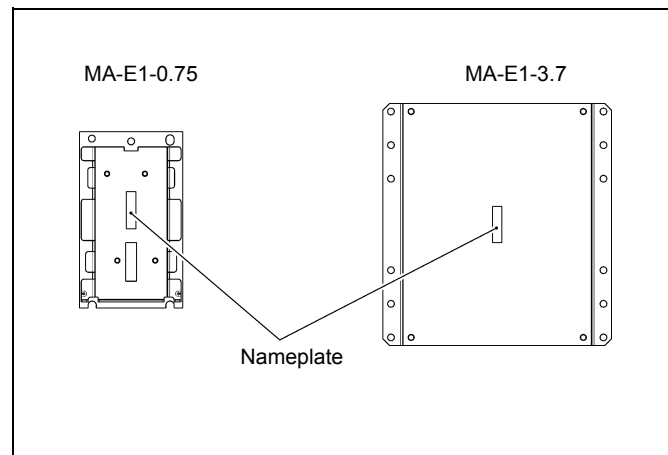

### 2. Panel-mount Adapter Models and Applicable Inverter Models

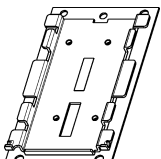
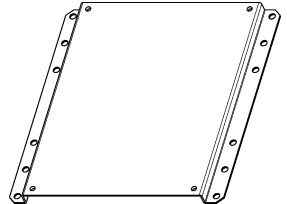
Panel-mount Adapter Models	Applicable Inverter Models	
	FRENIC-Multi series	FVR-E11S series
MA-E1-0.75 	FRN0.1E1S-2□** FRN0.2E1S-2□** FRN0.4E1S-2□** FRN0.75E1S-2□**	FVR0.1E11S-2 FVR0.2E11S-2 FVR0.4E11S-2 FVR0.75E11S-2
	FRN0.1E1S-7□** FRN0.2E1S-7□** FRN0.4E1S-7□**	FVR0.1E11S-7 FVR0.2E11S-7 FVR0.4E11S-7
MA-E1-3.7 	FRN3.7E1S-2□** FRN3.7E1S-4□** FRN2.2E1S-7□**	FVR3.7E11S-2 FVR3.7E11S-4 FVR2.2E11S-7

Note 1: A box (□) in the above table replaces A, E, or J depending on shipping destination.  
 Note 2: Asterisks (\*\*) in the above table replace alphanumerics which denote the following:  
 12: RS-485 communications card built-in type    1P: PG interface card built-in type  
 No number: Standard type

### 3. Installation Procedure

Four M4 screws are required to install a panel-mount adapter (1.2 mm thick) to the panel of your system. You should provide screws that match the panel.

#### ■ MA-E1-0.75

- (1) Secure the panel-mount adapter to the panel with four M4 screws (to be provided by the customer).  
 When replacing the FVR-E11S series with the FRENIC-Multi series, out of the three holes provided in the upper end of the panel-mount adapter, use the right and left holes. (The center hole is provided for replacement with other types of inverters.)
- (2) Press your FRENIC-Multi against the panel-mount adapter so that the FRENIC-Multi's lower rear corners come to above the end of lower tabs "B" of the panel-mount adapter and the cutout provided in the center of the inverter's rear side become fitted over upper tabs "A."
- (3) Slide down the FRENIC-Multi along the panel-mount adapter. Make sure that the holes provided in the lower rear corners of the FRENIC-Multi are fitted over the bosses on the panel-mount adapter.

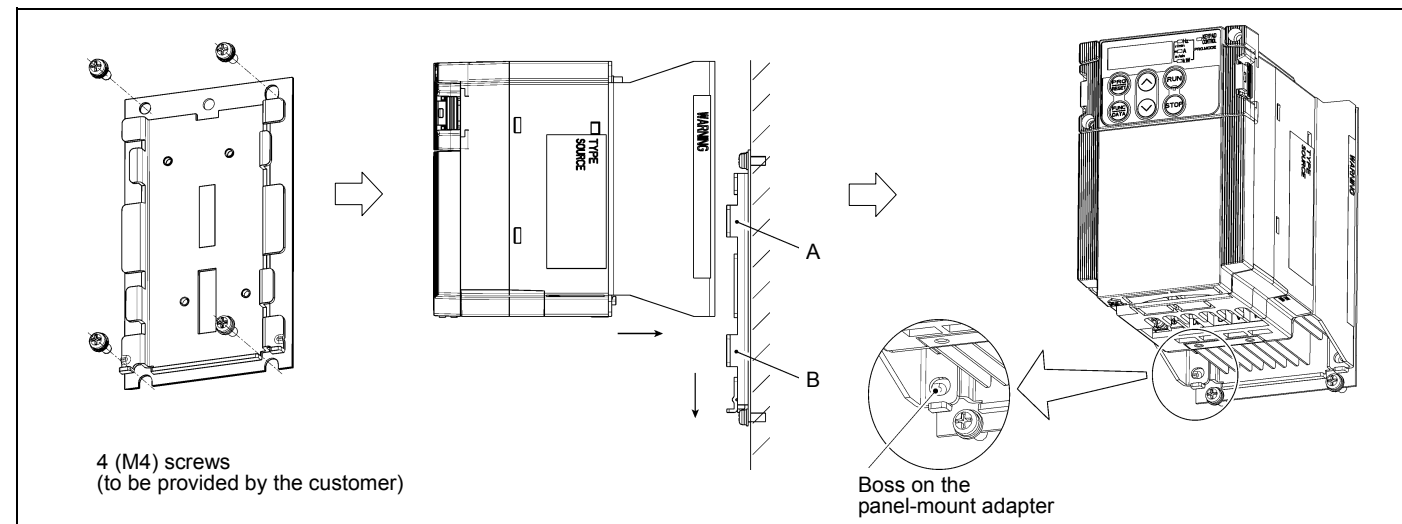

#### ■ MA-E1-3.7

- (1) Secure your FRENIC-Multi to the panel-mount adapter with four screws (M4x12) that come with the panel-mount adapter. (Tightening torque: 1.8 N·m)
- (2) Secure the panel-mount adapter holding the FRENIC-Multi to the panel of your system with four M4 screws (to be provided by the customer).

At each of the four corners of the panel-mount adapter are three mounting holes. Usually use the center holes. If using the center holes cannot assure an extra space of 100 mm or more above or below the installed FRENIC-Multi, use the upper or lower holes, respectively.

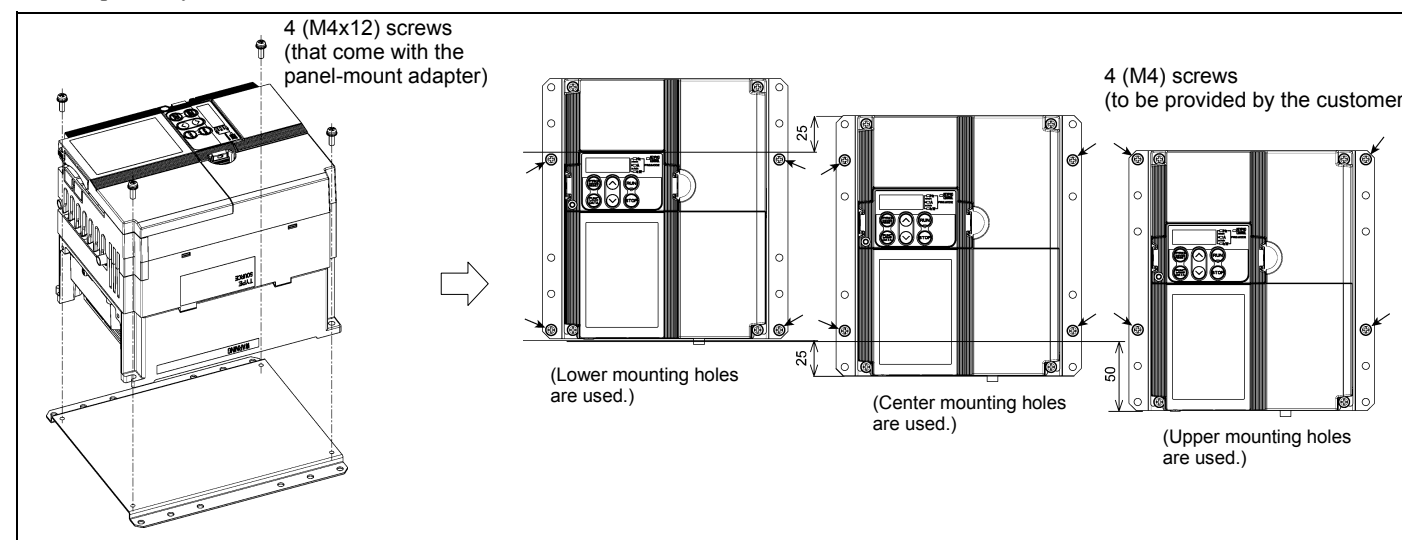

### Fuji Electric FA Components & Systems Co., Ltd.

Mitsui Sumitomo Bank Ningyo-cho Bldg., 5-7, Nihonbashi, Odemma-cho, Chuo-ku, Tokyo, 103-0011, Japan  
 Phone: +81 3 5847 8011    Fax: +81 3 5847 8172  
 URL: <http://www.fujielectric.co.jp/fcs/>